

DW1-31 DRILL JUMBO



Standard features

◆ Hydraulic drilling boom

- Special design heavy duty with double tripod suspension for accurate hydraulic parallel holding in all directions
- The rotary actuators is located in front of the boom,it can make the feed mechanism to rotary ± 180 degree.
- The heavy duty slider with high bending and torsion resistance, the working life is longer.
- The surface of slider covered by stainless steel sheaf.



◆ Rock drill

- The rock drill is from Montabert, it can drill the rock ($f \leq 15$) with high efficiency, which is five times than pneumatic rock drill.
- The rock drill with damping system for optimal consumable life.
- Longer life and lower loss than similar rock drill.

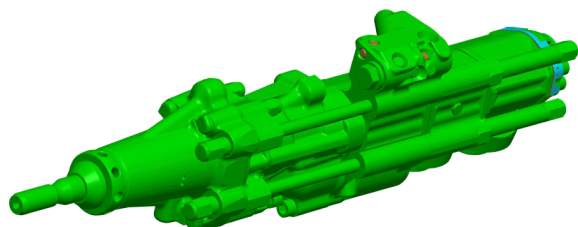

Specifications

Technical Parameters

Drill speed	0.8 - 3m/min
Drill rod length	4310/3700/3090mm
Hole diameter	Φ28 mm - Φ127 mm
Hole depth (once)	4015/3405/2795 mm
Cross section (W*H)	≤6.0 m *6.0 m
Traveling speed	12 Km/h
Rock drill	HC50/HC109 (Montabert)
Overall dimension (L*W*H)	11000*1650*2930/2230 mm
Weight	10000 kg

Boom

Boom	1 set
Feed extension	1250 mm
Parallel holding	Hydraulic
Feed roll-over	± 180°
Max. swinging angle	± 35°
Max.lifting angle	+65° / -30°
Max. feed lifting angle	+95° / -3°
Length of Telescopic	850 mm

Electrical system

Total installed power	55 + 2.2 + 2.2 kw
Main motor / Diesel	55 kw / 60 kw
Voltage	380V - 660V
Frequence	50-60 Hz

Hydraulic system

Hydraulic pumps (Motor / Diesel)	1 gear pump+1 plunger pump (Motor) 2 gear pump+ 1 plunger pump
Max.system pressure	23 Mpa (Drill) / 42 Mpa (Traveling)
Hydraulic oil tank	150 L
Cooler type	water cooler
operator control panel	1 pc

Diesel

Model	Cummins B3.3-80
Power	60 kw
Aspiration	Turbocharged
Rated power/RPM	80/2200 (HP / RPM)
Max. torque/RPM	292/1600 (N·m / RPM)
Displacement	Tier2
Weight	275 Kg